



Butcher Boy[®] Machines



BUTCHER BOY AU56 Autofeed Grinder



MPBS INDUSTRIES

Commercial Food Processing & Packaging Equipment

323-268-8514 800-421-6265 323-386-4058 (fax)

www.mpbs.com

Features:

Stainless steel construction
Fabricated to USDA standards

O/A dimensions: +/- 69 L x 26 W x 106-1/2" H

- Stainless steel legs have 12" adjustment
 - Allows for 28 to 40" clearance under the grinder

Grinding capacity: +/- 12000 lb per hour (using a 1/2" holes plate)

Fully automatic feed

High output grinder for fresh or tempered meat

Hopper capacity: +/- 175 lb

Alan Bradley safety switches

UL certified electronics

Standard Safety Features:

- Lockout
- Safety switch at tub grid cover
- Feed box cover switch
- Control voltage 24 VAC

Plate Size:

- Size 56 plate
 - 6" Barrel, 6" plate

Motor:

- 208/230/460V / 60 Hz / 3 Ø
- Heavy-duty, 25 HP TEFC
- Conforms to NEMA specifications

Motor Controls:

- All machines come with motor controls as standard equipment
- User to supply over-current protection

Includes:

- #1 Hopper with safety grid hinged on side
- Adjustable legs
- Spurt guard
- Spanner wrench
- Instruction manual and parts list

Weight:

- Shipping: +/- 1570 lbs

DIMENSIONS

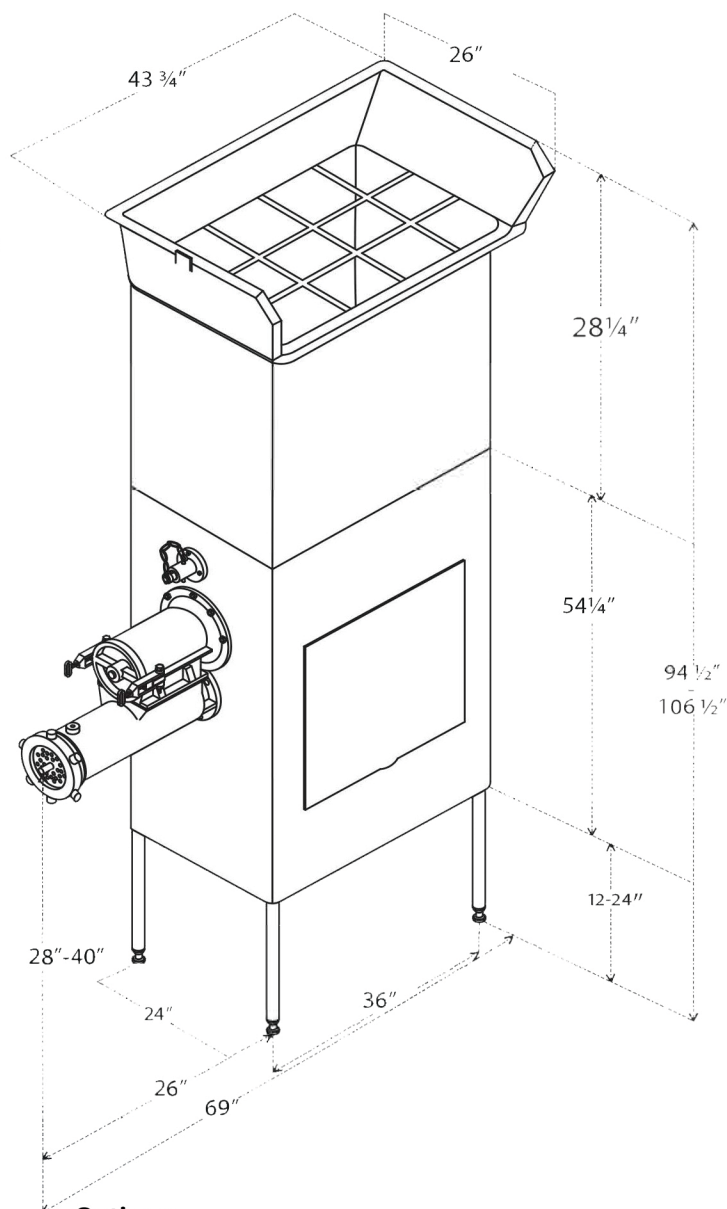

Options:

- Lid cover
- Various hoppers
- Conveyor for easy loading
- Platform steps for operator to hand load machine
- Electrical

All specifications are subject to change without notice.

Manufactured by:
BUTCHER BOY MACHINES INT LLC
640 MULBERRY AVENUE
SELMER TN 38375

Distributed by:
MPBS INDUSTRIES
2820 EAST WASHINGTON BLVD
LOS ANGELES CA 90023
www.mpbs.com
contact@mpbs.com